

STAPLE HERE

FOR OFFICIAL USE

--	--	--	--	--	--

## X033/10/01

NATIONAL  
QUALIFICATIONS  
2012

FRIDAY, 18 MAY  
1.00 PM – 3.00 PM

GRAPHIC  
COMMUNICATION  
INTERMEDIATE 1

Fill in these boxes and read what is printed below.

Full name of centre

Town

Forename(s)

Surname

Date of birth

Day Month Year

--	--	--	--	--	--	--	--

Scottish candidate number

--	--	--	--	--	--	--	--	--	--	--	--

Number of seat

**70 marks are allocated to this paper**

- 1 Answer **all** questions.
- 2 Read each question carefully before you answer.
- 3 Written answers may be in **ink** or **pencil**.
- 4 Drawings and sketches **must be in pencil**.
- 5 Dimensions are given in millimetres or as stated.
- 6 Orthographic drawings are in third angle projection.

**At the end of the examination**

check that your name is on every sheet;  
put the sheets in correct numerical order;  
place this sheet on top of the others;  
join all sheets together by **stapling** at the top left-hand corner;  
before leaving the examination room, you must give these sheets to the Invigilator  
(if you do not you may lose all the marks for this paper).

Question	Marks
1	
2	
3	
4	
5	
6	
7	
8	
9	
Total Marks	



[BLANK PAGE]

1

The following computer devices can be found in a school's computer suite.

- |               |         |         |            |
|---------------|---------|---------|------------|
| Keyboard      | Plotter | Monitor | Hard drive |
| Laser printer | Mouse   | Scanner | DVD        |

Identify, from the list above:

- (a) two **output** devices; ..... 1  
 ..... 1
- (b) two **input** devices. .... 1  
 ..... 1

(4 marks)

2

A family are planning to decorate their house to make it more appealing. They decide on blue walls for one of the rooms.

- (a) State whether blue is an **advancing** or a **receding** colour.  
 ..... 1
- (b) State what should be added to blue to make a **shade** of blue.  
 ..... 1
- (c) State a **secondary colour** that would **harmonise** with blue.  
 ..... 1
- (d) State how a **secondary colour** is created.  
 ..... 1

(4 marks)

3

A café is looking for a new design for a menu. Two versions of the menu are shown below.



Design A



Design B

- (a) State the page orientation that has been used for the menu.  
 ..... 1
- (b) State the **single** command that would be used to change the text "Menu 1" in **Design A**, so that it reads vertically, as in **Design B**.  
 ..... 1
- (c) State the **single** command that would be used to produce the graphic in **Design B** from the original graphic image.  
 ..... 1

(3 marks)

4

An elevation of a spice jar is shown below. With reference to British Standards:

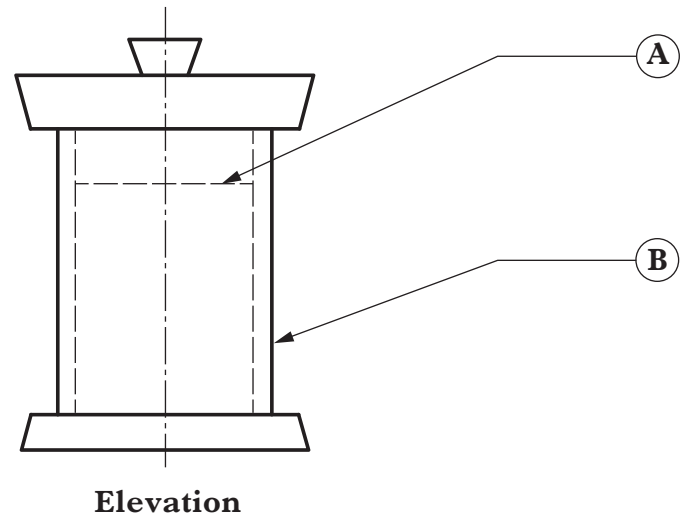

(a) Identify the following line types.

- (i) Line type **A**..... 1
- (ii) Line type **B**..... 1

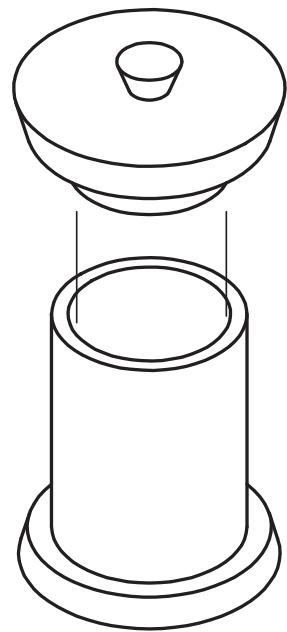

**Drawing Y**

(b) State the type of pictorial drawing shown in **Drawing Y** above.

..... 1  
**(3 marks)**

5

The plan view for a proposed design office is given below.

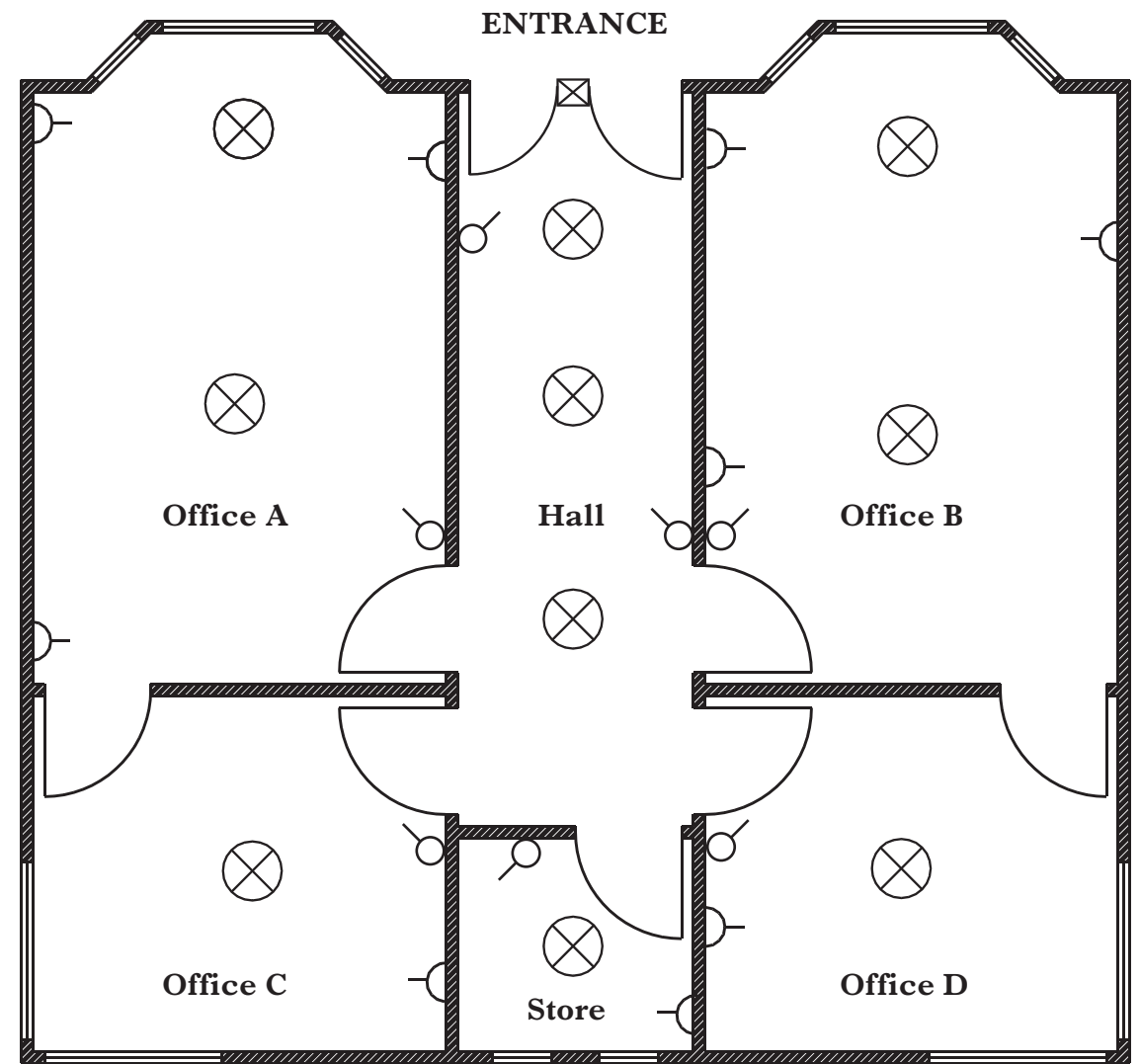

- (a) State how many sockets are in **office A**. ..... 1
- (b) State how many lamps are in the **hall**. ..... 1
- (c) State how many doors open **into** the hall. .... 1

**(3 marks)**

6

An isometric view, a part view and the elevation of a baby changing unit are given.

Draw full size, in the positions indicated:

- (a) the end elevation;
- (b) the plan.

All wall thicknesses are 5 mm.

Show all hidden detail.

(12 marks)

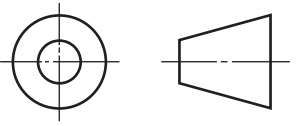
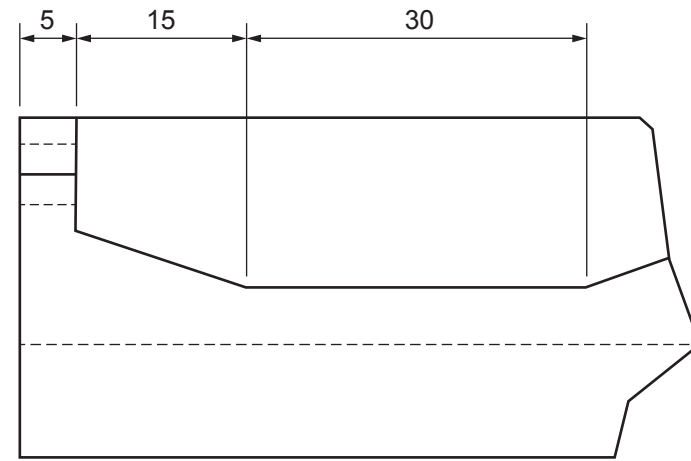

6

Part View  
NOT TO SCALE

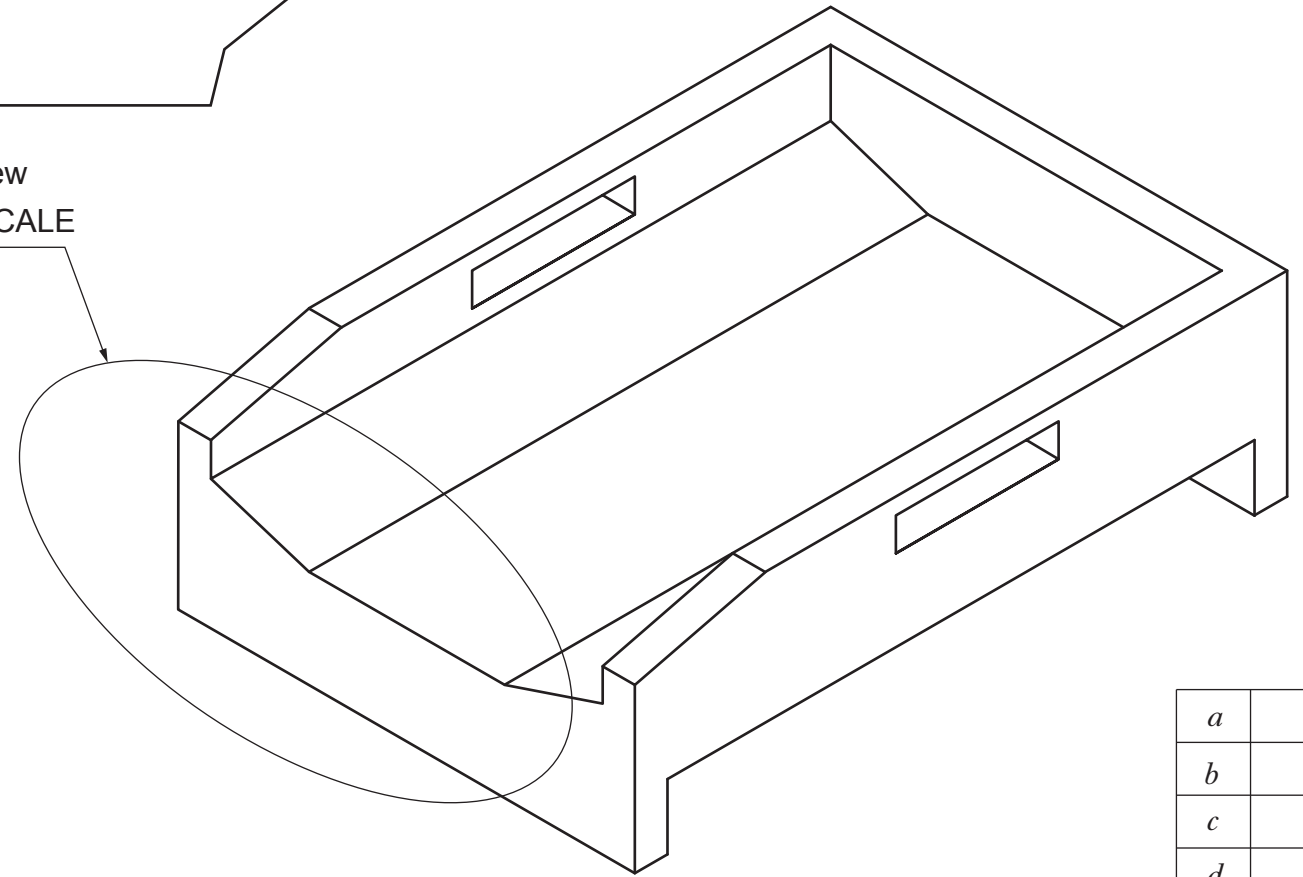

Isometric View  
Scale 1:1



Plan

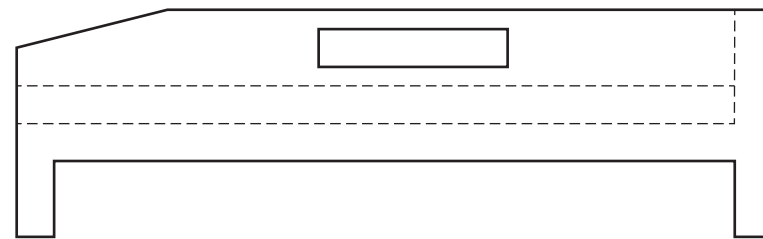

Elevation



End Elevation

<i>a</i>	
<i>b</i>	
<i>c</i>	
<i>d</i>	
<i>e</i>	
<i>f</i>	
<i>g</i>	
<i>h</i>	
<i>i</i>	
<i>j</i>	
<i>k</i>	
<i>l</i>	
<i>m</i>	
<i>n</i>	

Candidate's Name \_\_\_\_\_

7

The incomplete plan and end elevation of a solar powered garden light with a square base are given. A pictorial view is shown opposite.

Draw full size, in the positions indicated:

- (a) the **completed** plan;
- (b) the elevation;
- (c) the development of the curved surface of the light opened along the seam **A-A**.

(14 marks)

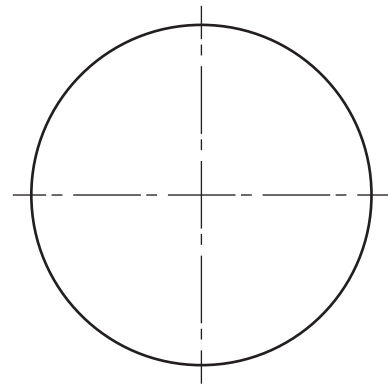

Plan

Elevation

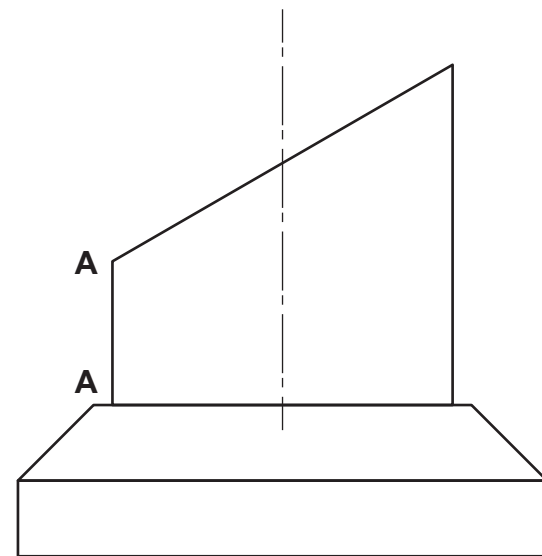

End Elevation

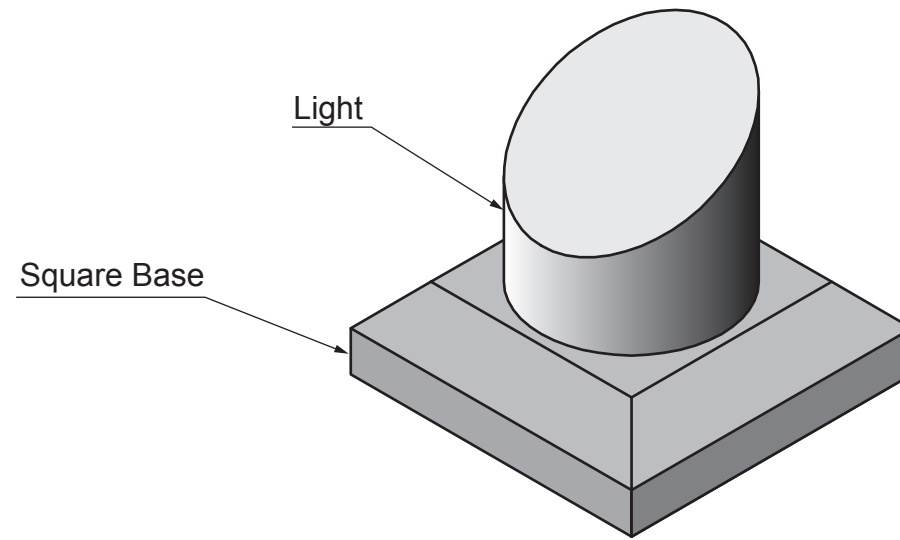

Pictorial View

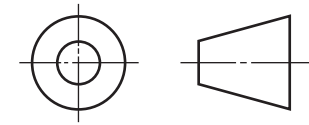

7

<i>a</i>	
<i>b</i>	
<i>c</i>	
<i>d</i>	
<i>e</i>	
<i>f</i>	
<i>g</i>	
<i>h</i>	
<i>i</i>	
<i>j</i>	
<i>k</i>	
<i>l</i>	
<i>m</i>	
<i>n</i>	



Candidate's Name \_\_\_\_\_

8

The elevation, end elevation and plan of a washroom are given.

Draw, to the given scale, a **planometric** view of the washroom, in the position indicated.

Do not show the handles.

Do not show hidden detail.

(13 marks)

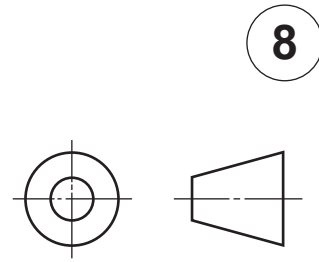
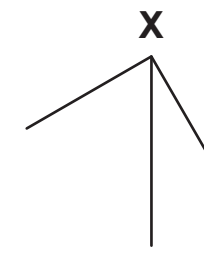

8

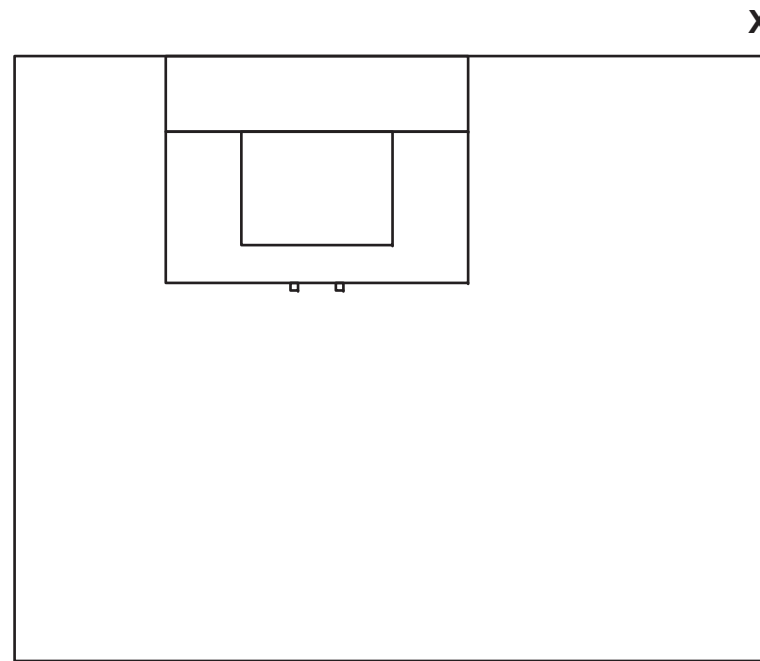

Plan

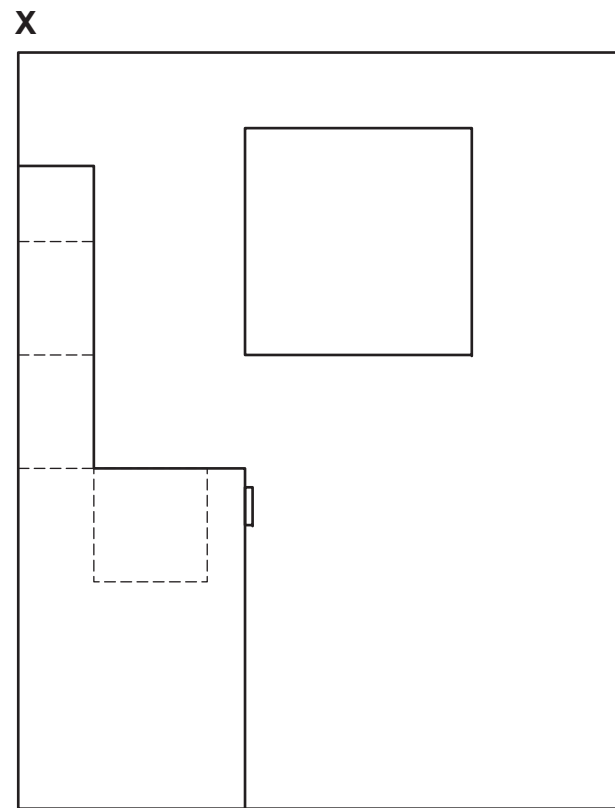

End Elevation

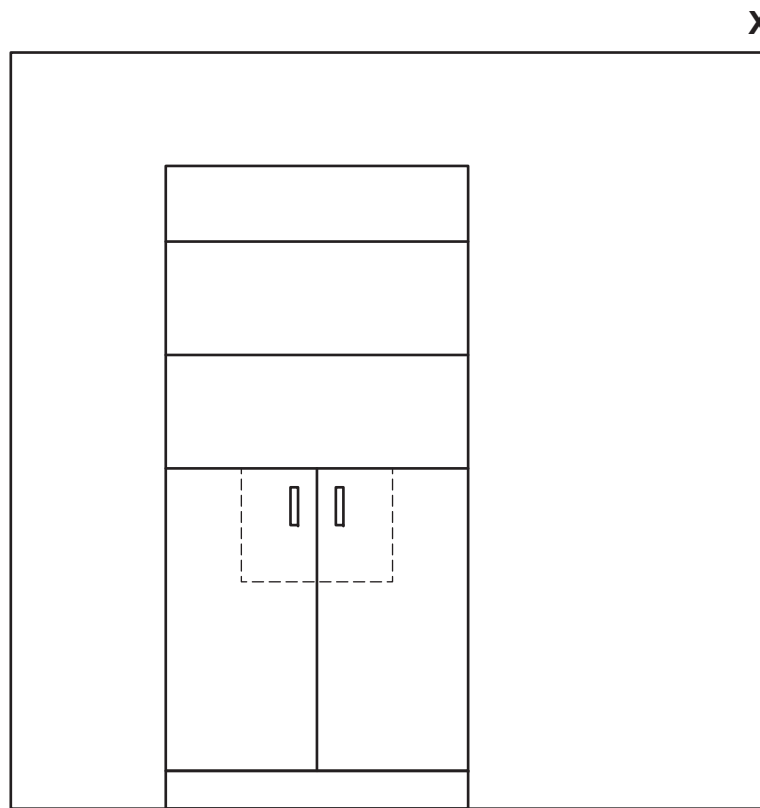

Elevation

Planometric

<i>a</i>	
<i>b</i>	
<i>c</i>	
<i>d</i>	
<i>e</i>	
<i>f</i>	
<i>g</i>	
<i>h</i>	
<i>i</i>	
<i>j</i>	
<i>k</i>	
<i>l</i>	
<i>m</i>	
<i>n</i>	

The elevation and end elevation of a battery charger and battery are given.

An exploded pictorial view is shown opposite.

Draw, full size in the position indicated:

(a) the **assembled** elevation;

**Show all hidden detail.**

(b) the **assembled** sectional end elevation on **A-A**.

**Do not show hidden detail.**

(14 marks)

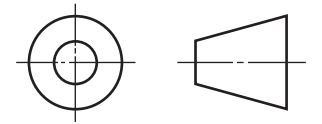
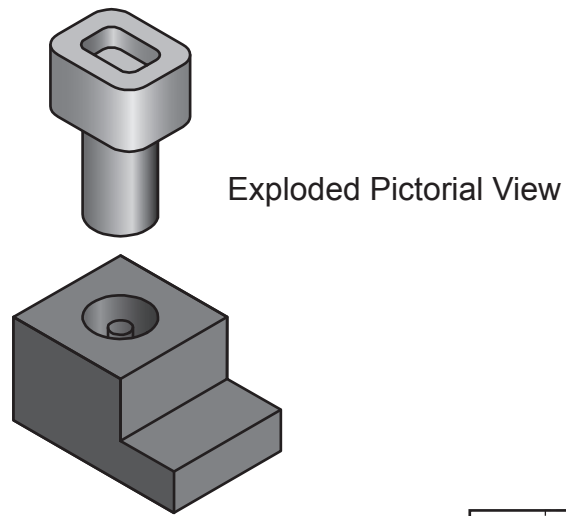

a	
b	
c	
d	
e	
f	
g	
h	
i	
j	
k	
l	
m	
n	

A →

A →



Sectional End Elevation A - A

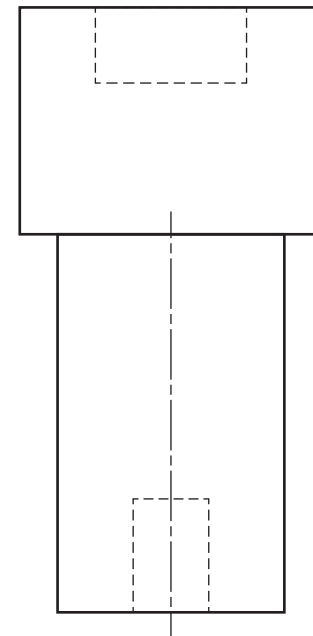

End Elevation

Battery

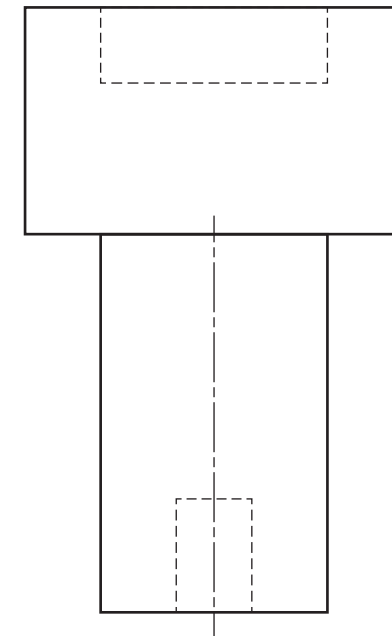

Elevation

Scale 1:1

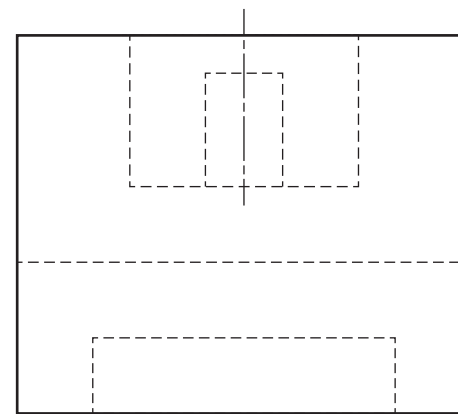

End Elevation

Charger

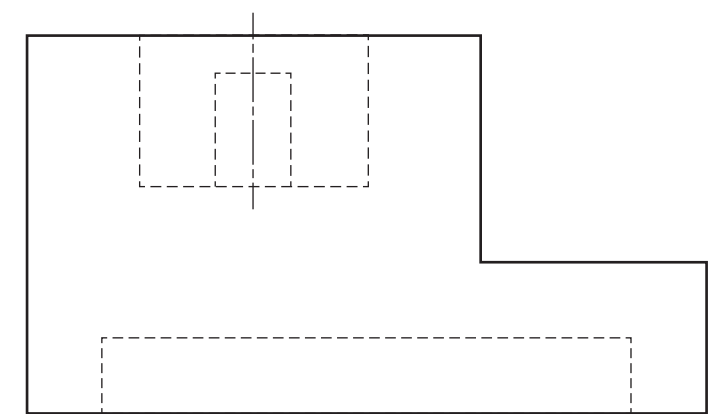

Elevation